

CHIMNEY FLASHING CROSS SECTION

NTS

NOTES:

1. CHIMNEY FLASHING TRIM IS DESIGNED TO FLASH AROUND CHIMNEYS AND LARGE PENETRATIONS (E.G. SKYLIGHTS). CH1 AND CH7 ARE INTENDED FOR USE WITH MOST EXPOSED FASTENER AND STANDING SEAM PROFILES. OTHER USE MAY BE ACCEPTABLE IF DESIGNER DETERMINES FITNESS OF USE.
2. THIS IS A GENERIC DETAIL FOR GENERAL PURPOSE USE. SPECIAL CONDITIONS MAY REQUIRE ALTERNATIVE DESIGN BY THE INSTALLER OR ARCHITECT/ENGINEER.
3. LARGE PENETRATIONS SUCH AS CHIMNEYS MAY REQUIRE CRICKETS OR OTHER DETAILING. CHECK WITH LOCAL BUILDING CODES.
4. USE SIDEWALL DETAILS FOR CHIMNEY SIDES AND ENDWALL DETAIL FOR DOWNHILL END OF CHIMNEY.

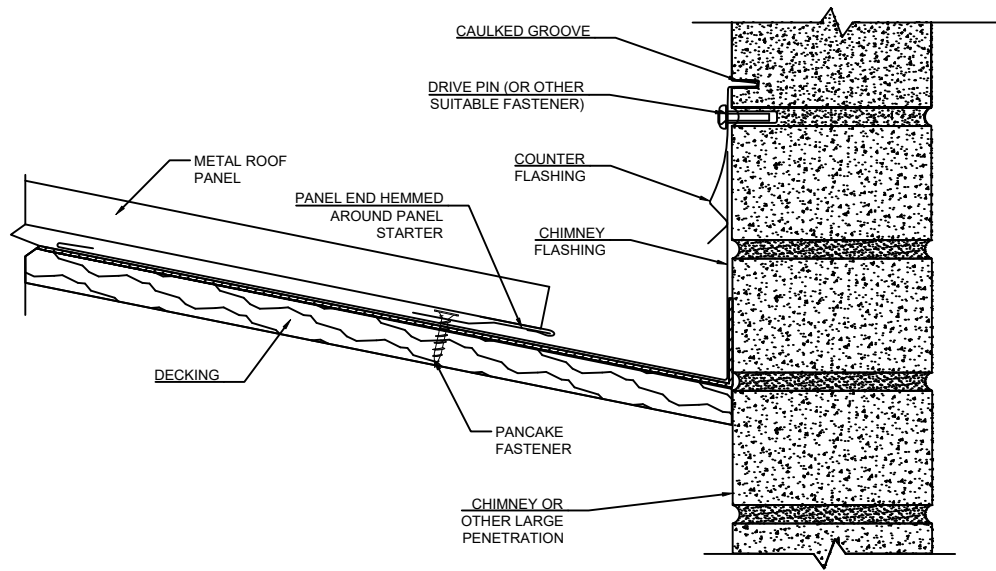

CHIMNEY FLASHING PLAN VIEW

NTS

NOTES:

1. VIEW AA: CHIMNEY FLASHING CROSS SECTION
2. VIEW BB: SIDE WALL CROSS SECTION
3. VIEW CC: END WALL CROSS SECTION
4. FLASH BEGINNING FROM DOWNHILL SIDE; OVERLAP SUCCESSIVE UPHILL FLASHING TO PROVIDE CONTINUOUS DRAINAGE PATH.

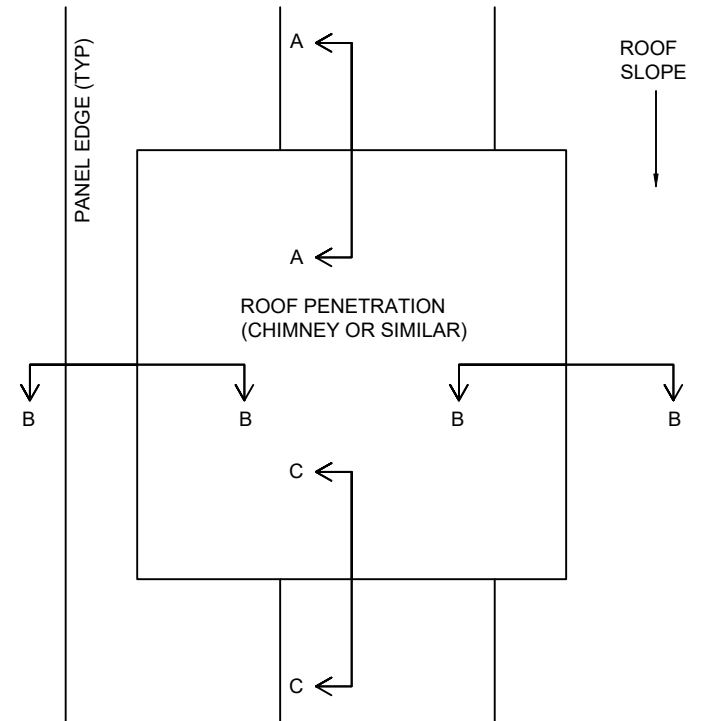

CH1 DIMENSIONS

NTS

NOTES:

1. USE DIMENSIONS SHOWN. DO NOT SCALE.
2. CH1 CAN BE USED WITH MOST PANEL PROFILES.

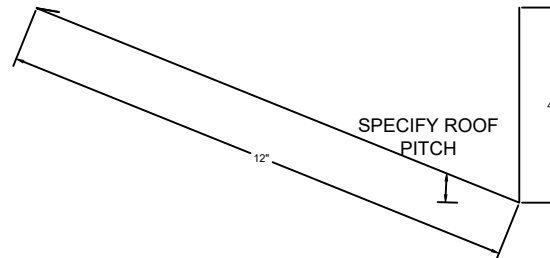

Details master.dwg

2/15/2017



STANDING SEAM TRIMS

CHIMNEY FLASHING

GULF COAST SUPPLY & MFG., LLC
14429 SW 2ND PLACE, SUITE G30
NEWBERRY, FL 32669
352-498-0778 Fax 352-498-7852

<http://www.gulfcoastsupply.com>

HIGH SIDE RIDGE CROSS SECTION

NTS

NOTES:

1. HIGH SIDE RIDGE CAP IS RECOMMENDED FOR USE AT THE RIDGE OF A MONOSLOPE ROOF. DIFFERENT STYLES OF RIDGE CAP ARE AVAILABLE SUBJECT TO DESIGNER'S SELECTION. OTHER USE MAY BE ACCEPTABLE IF DESIGNER DETERMINES FITNESS OF USE.
2. THIS IS A GENERIC DETAIL FOR GENERAL PURPOSE USE. SPECIAL CONDITIONS MAY REQUIRE ALTERNATIVE DESIGN BY THE INSTALLER OR ARCHITECT/ENGINEER.

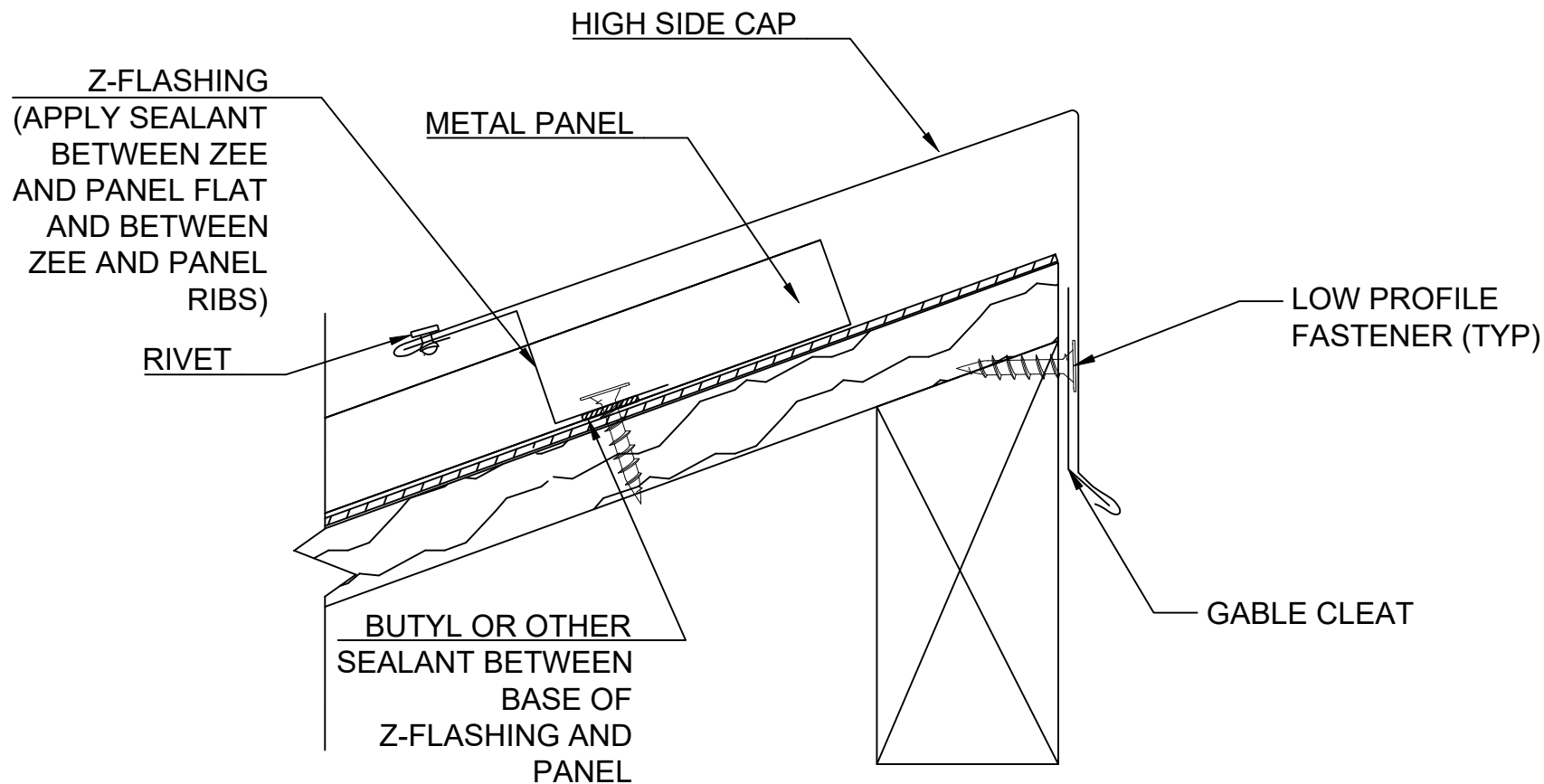

Details master.dwg

12/12/2017

SIDEWALL/ENDWALL CROSS SECTION

NTS

NOTES:

1. SIDEWALL IS RECOMMENDED FOR USE WHERE A WALL INTERSECTS A ROOF SECTION PARALLEL TO THE PANEL LENGTH. ENDWALL TRIM IS RECOMMENDED WHERE A WALL INTERSECTS A ROOF SECTION PERPENDICULAR TO THE PANEL LENGTH.
2. DIFFERENT STYLES OF WALL TRIM ARE AVAILABLE SUBJECT TO DESIGNER'S SELECTION. OTHER USE MAY BE ACCEPTABLE IF DESIGNER DETERMINES FITNESS OF USE.
3. DIFFERENT METHODS OF COUNTER FLASHING MAY BE USED TO PROVIDE A WEATHERTIGHT TRANSITION.
4. THIS IS A GENERIC DETAIL FOR GENERAL PURPOSE USE. SPECIAL CONDITIONS MAY REQUIRE ALTERNATIVE DESIGN BY THE INSTALLER OR ARCHITECT/ENGINEER.

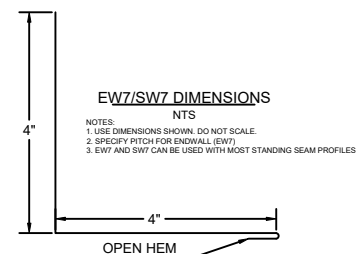
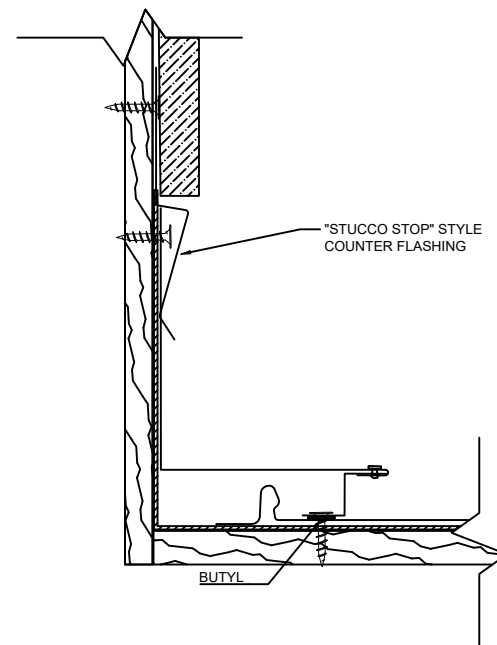
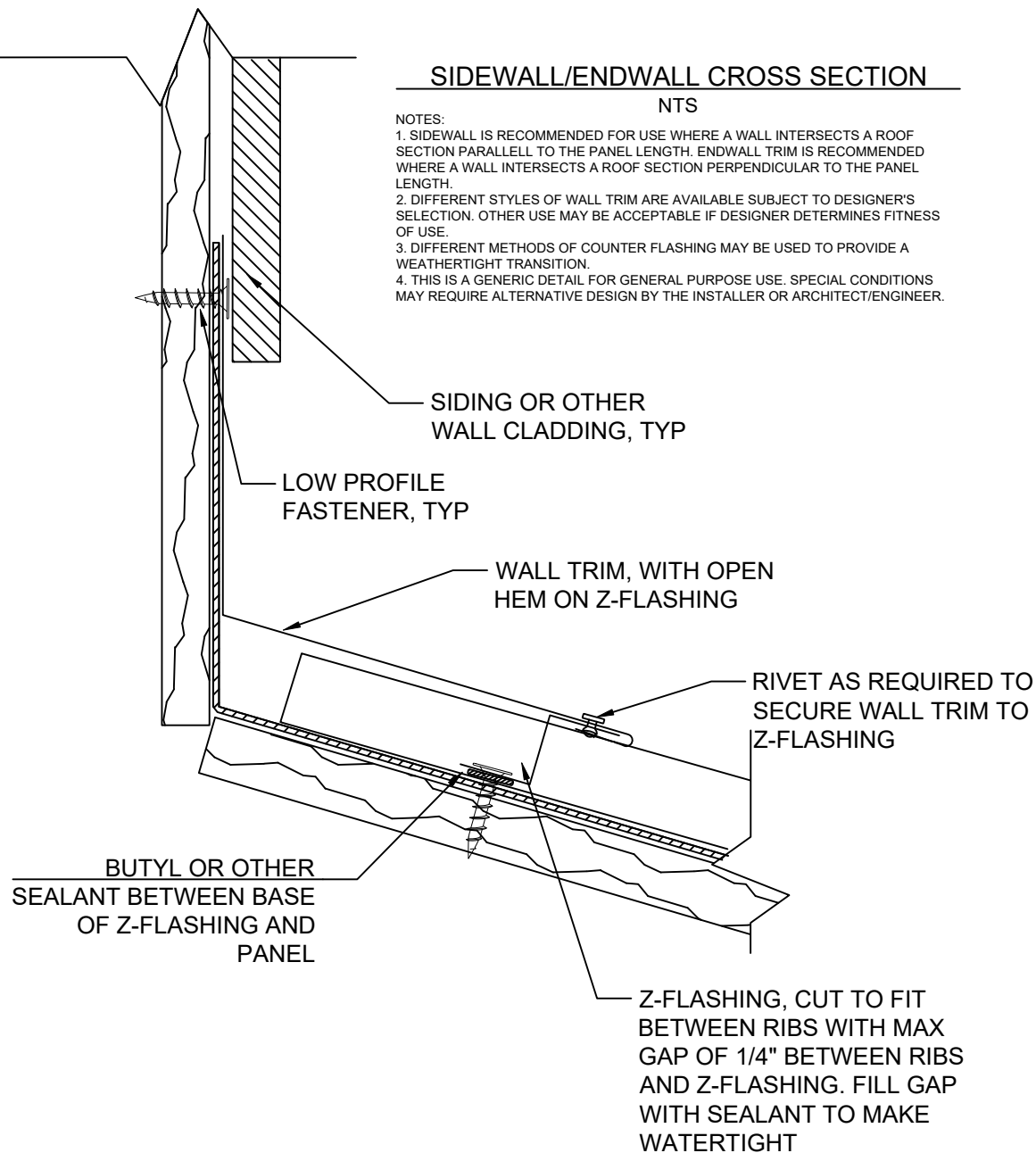

Details master.dwg

2/15/2017



STANDING SEAM TRIMS

SIDEWALL/ENDWALL

GULF COAST SUPPLY & MFG., LLC
14429 SW 2ND PLACE, SUITE G30
NEWBERRY, FL 32669
352-498-0778 Fax 352-498-7852

<http://www.gulfcoastsupply.com>

RIDGE CROSS SECTION

NTS

*NOTES:

1. RIDGE CAP IS RECOMMENDED FOR USE AT ROOF EAVES. DIFFERENT STYLES OF RIDGE CAP ARE AVAILABLE SUBJECT TO DESIGNER'S SELECTION. OTHER USE MAY BE ACCEPTABLE IF DESIGNER DETERMINES FITNESS OF USE.
2. THIS IS A GENERIC DETAIL FOR GENERAL PURPOSE USE. SPECIAL CONDITIONS MAY REQUIRE ALTERNATIVE DESIGN BY THE INSTALLER OR ARCHITECT/ENGINEER.
3. THE PANEL END ABOVE THE Z-FLASHING CAN BE BENT UP FOR ADDITIONAL WATERTIGHTNESS PERFORMANCE.

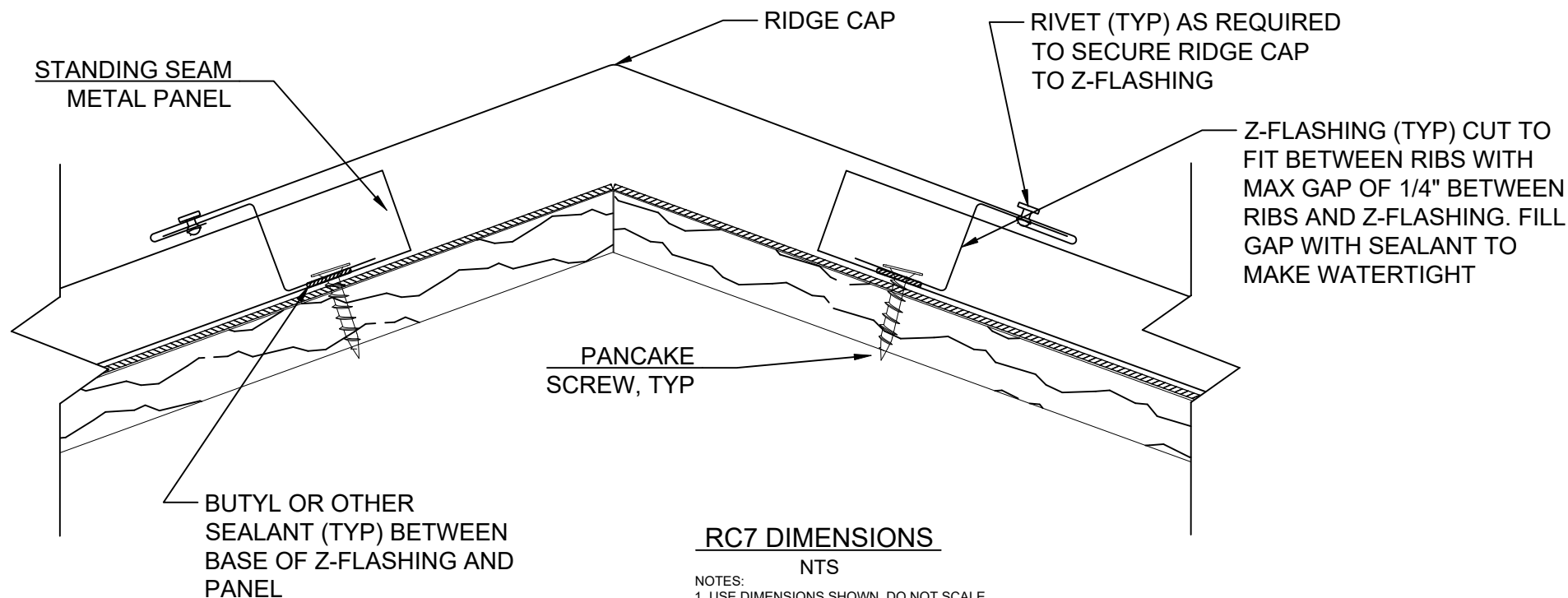

RC7 DIMENSIONS

NTS

NOTES:

1. USE DIMENSIONS SHOWN. DO NOT SCALE.
2. RC7 CAN BE USED WITH MOST PANEL SYSTEMS AND MOST PROJECTS.

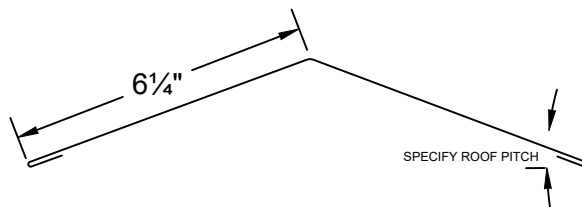

Details master.dwg

12/12/2017

EAVE CROSS SECTION

NTS

NOTES:

1. EAVE DRIP AND FASCIA ARE RECOMMENDED FOR USE AT ROOF EAVES. DIFFERENT STYLES OF EAVE DRIP ARE AVAILABLE SUBJECT TO DESIGNER'S SELECTION. OTHER USE MAY BE ACCEPTABLE IF DESIGNER DETERMINES FITNESS OF USE.
2. THIS IS A GENERIC DETAIL FOR GENERAL PURPOSE USE. SPECIAL CONDITIONS MAY REQUIRE ALTERNATIVE DESIGN BY THE INSTALLER OR ARCHITECT/ENGINEER.

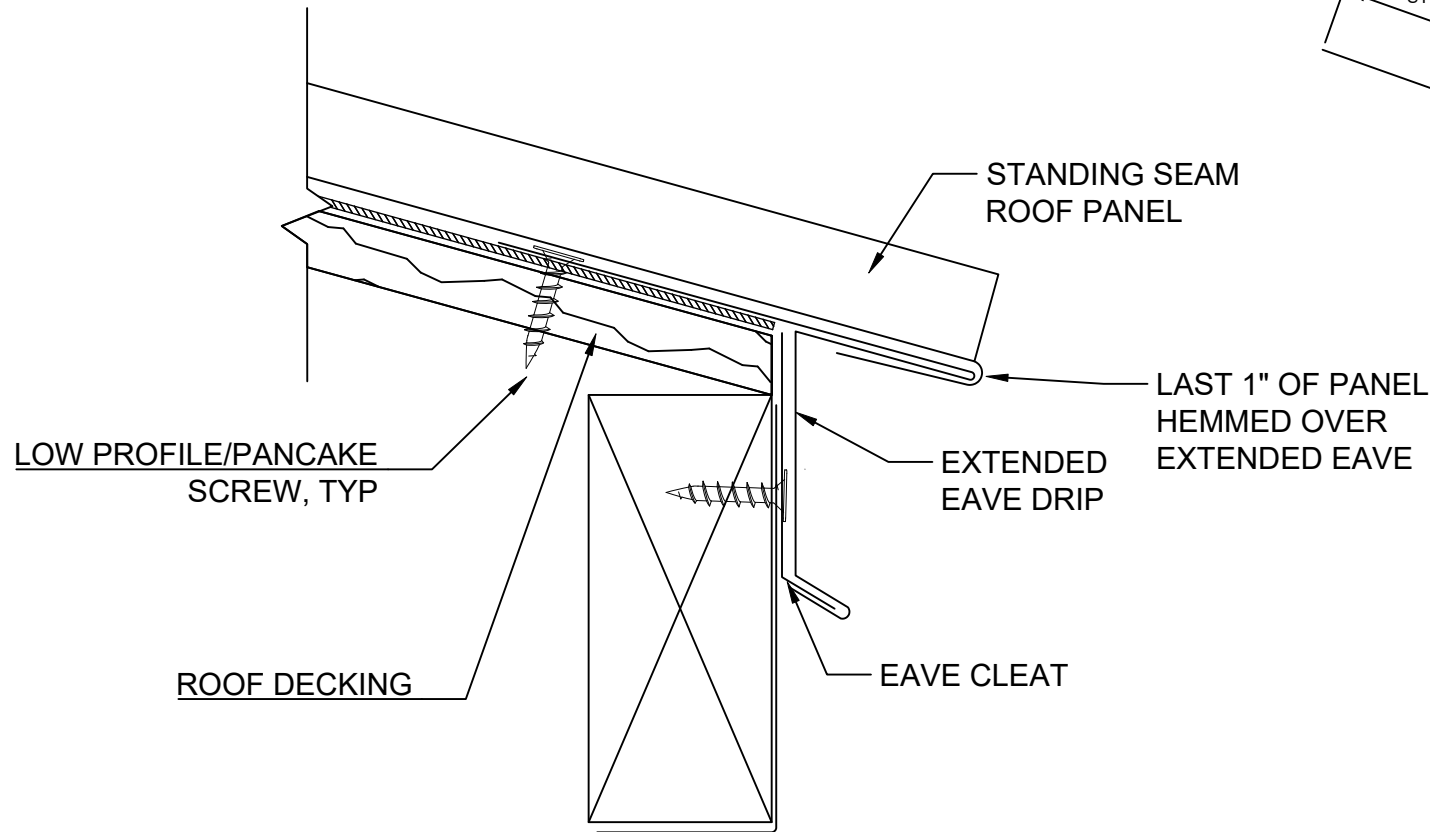

ED7 DIMENSIONS

NTS

NOTES:

1. USE DIMENSIONS SHOWN. DO NOT SCALE.
2. ED7 CAN BE USED WITH MOST PANEL SYSTEMS AND MOST PROJECTS

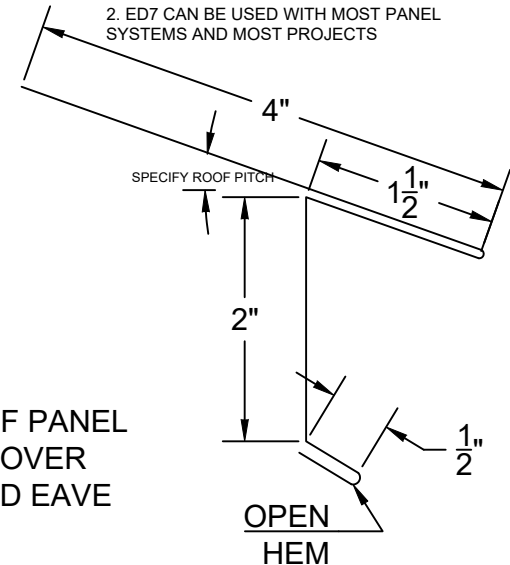

Details master.dwg

12/12/2017

GABLE CROSS SECTION

NTS

NOTES:

1. GABLE/RAKE TRIM IS USED WHERE THE ROOF TERMINATES AT A PANEL SIDE. DIFFERENT STYLES ARE AVAILABLE SUBJECT TO DESIGNER'S SELECTION. OTHER USE MAY BE ACCEPTABLE IF DESIGNER DETERMINES FITNESS OF USE.
2. THIS IS A GENERIC DETAIL FOR GENERAL PURPOSE USE. SPECIAL CONDITIONS MAY REQUIRE ALTERNATIVE DESIGN BY THE INSTALLER OR ARCHITECT/ENGINEER.

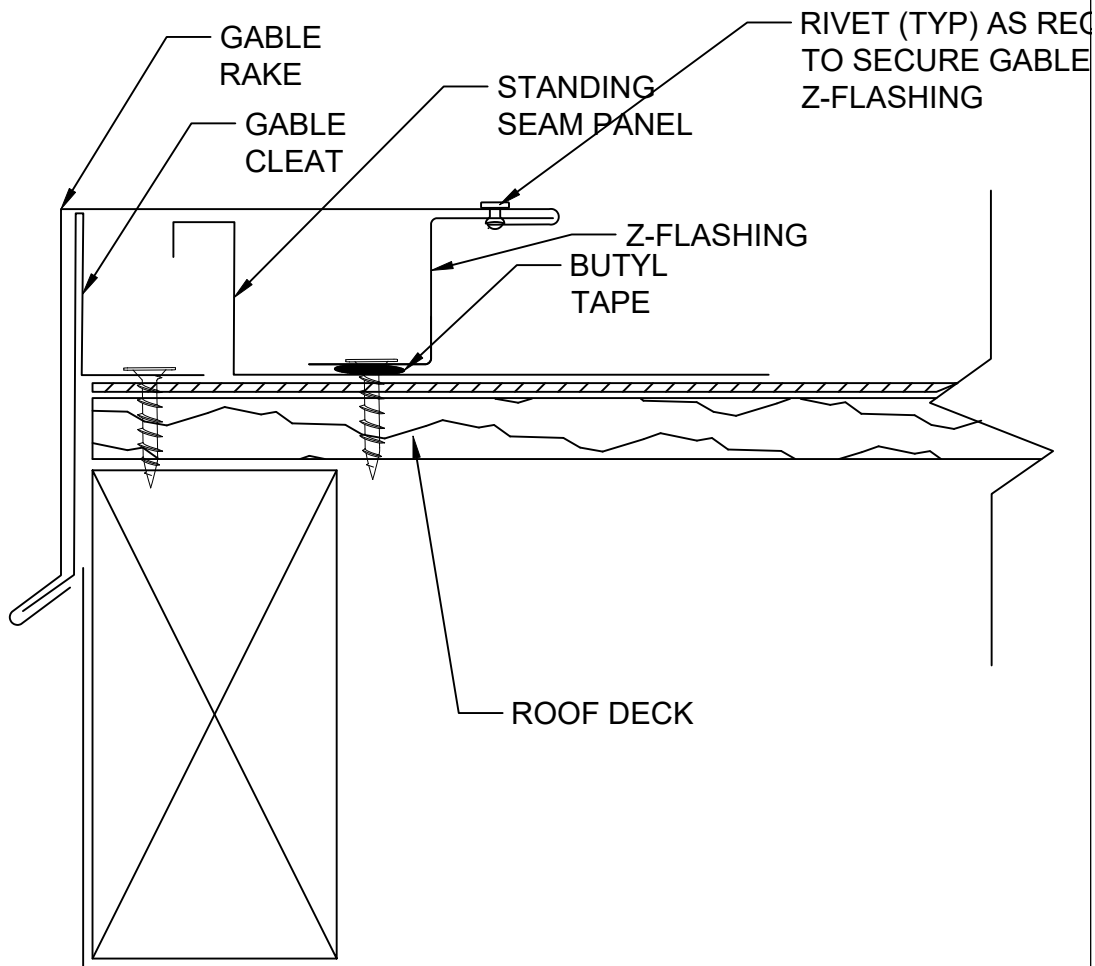

EF7 AND GC7 DIMENSIONS

NTS

NOTES:

1. USE DIMENSIONS SHOWN. DO NOT SCALE.
2. EF7 IS DESIGNED FOR USE WITH GULFLOK

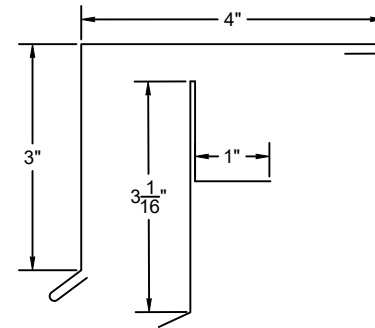

EF9 AND GC9 DIMENSIONS

NTS

NOTES:

1. USE DIMENSIONS SHOWN. DO NOT SCALE.
2. EF9 IS DESIGNED FOR USE WITH GULFSEAM

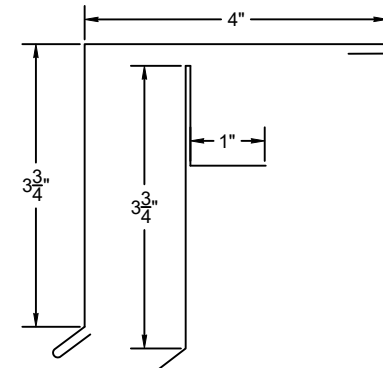

EF11 AND GC11 DIMENSIONS

NTS

NOTES:

1. USE DIMENSIONS SHOWN. DO NOT SCALE.
2. EF11 IS DESIGNED FOR USE WITH MEGALOC

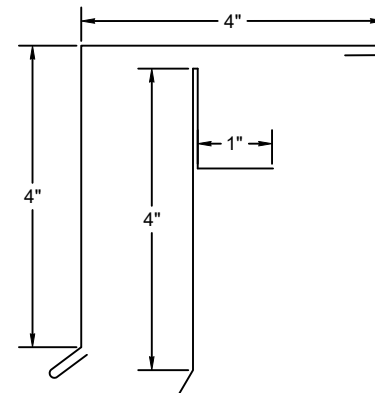

EF15 AND GC15 DIMENSIONS

NTS

NOTES:

1. USE DIMENSIONS SHOWN. DO NOT SCALE.
2. EF15 IS DESIGNED FOR USE WITH VERSALOC

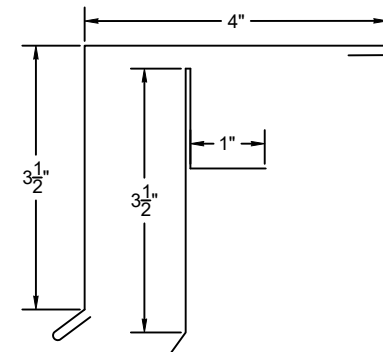

Details master.dwg

12/12/2017

VALLEY CROSS SECTION

NTS

NOTES:

1. VALLEY FLASHING IS USED AT THE LOW POINT WHERE TWO ROOF SECTIONS MEET. DIFFERENT STYLES ARE AVAILABLE SUBJECT TO DESIGNER'S SELECTION. OTHER USE MAY BE ACCEPTABLE IF DESIGNER DETERMINES FITNESS OF USE.
2. THIS IS A GENERIC DETAIL FOR GENERAL PURPOSE USE. SPECIAL CONDITIONS MAY REQUIRE ALTERNATIVE DESIGN BY THE INSTALLER OR ARCHITECT/ENGINEER.

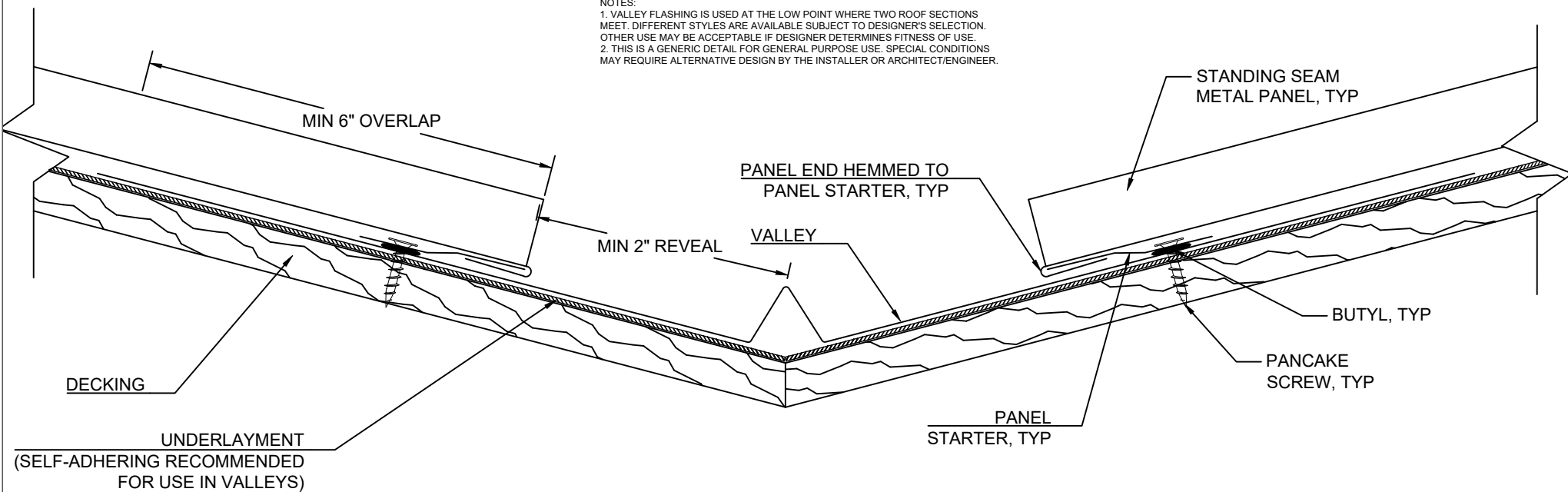

PV2 DIMENSIONS

NTS

NOTES:

1. USE DIMENSIONS SHOWN. DO NOT SCALE.
2. PV2 CAN BE USED WITH MOST PROFILES AND FOR MOST PROJECTS

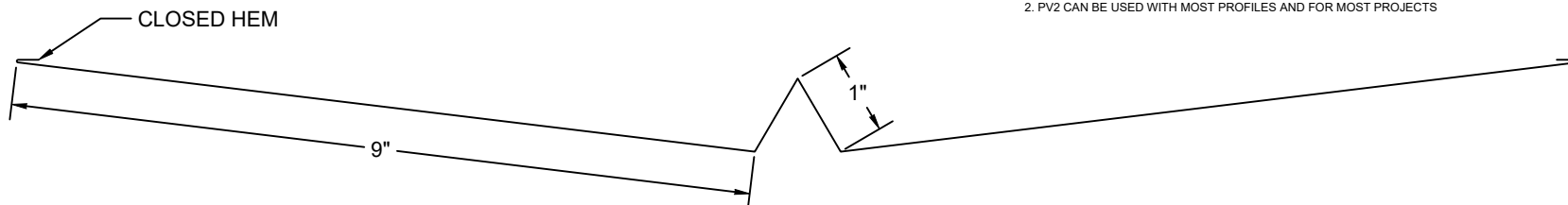

Details master.dwg

12/12/2017



STANDING SEAM TRIMS

VALLEY FLASHING

GULF COAST SUPPLY & MFG., LLC
14429 SW 2ND PLACE, SUITE G30
NEWBERRY, FL 32669
352-498-0778 Fax 352-498-7852

<http://www.gulfcoastsupply.com>

VENT PIPE OR SIMILAR
PENETRATION

PIPE BOOT

FASTENER,
TYP

SEALANT BETWEEN PANEL
AND BASE OF PIPE BOOT

PANEL RIB, TYP

PIPE BOOT PLAN VIEW

NTS

NOTES:

1. PIPE BOOTS ARE DESIGNED TO FLASH AROUND PIPES AND SIMILAR PENETRATIONS.
2. TYPICAL INSTALLATION PROCESS: CUT OPENING OF PIPE BOOT TO FIT TIGHTLY AROUND PIPE. APPLY SEALANT TO BASE OF PIPE BOOT. SLIDE BOOT OVER PIPE. FORM TO ROOF PROFILE. FASTEN PIPE BOOT WITH FASTENERS AT 1-2" OC OR AS REQUIRED TO ENSURE TIGHT FIT. APPLY ADDITIONAL SEALANT AS REQUIRED.
3. WHENEVER POSSIBLE, PLACE THE PENETRATION IN THE CENTER OF THE PAN. IF PENETRATION MUST FALL ON PANEL RIB, PIPE BOOT MAY BE INSTALLED ON RIB. EXTREME CARE MUST BE EXERCISED TO ENSURE THE BASE OF THE PIPE BOOT HAS SUFFICIENT SEALANT, THAT THE BASE IS WELL FORMED TO THE RIB, AND THAT SUFFICIENT FASTENERS ARE USED TO MAINTAIN A WATERTIGHT SEAL. APPLY ADDITIONAL SEALANT AFTER INSTALLATION IF REQUIRED.
4. SIZE PIPE BOOT TO FIT THE PIPE/PENETRATION AND PANEL IN USE.
5. THIS IS A GENERIC DETAIL FOR GENERAL PURPOSE USE. SPECIAL CONDITIONS MAY REQUIRE ALTERNATIVE DESIGN BY THE INSTALLER OR ARCHITECT/ENGINEER.
6. IF CONSTRAINT OF THERMAL MOVEMENT IS A CONCERN FOR LONG PANEL RUNS, DESIGNER SHOULD CONSIDER INSTALL OPTIONS TO AVOID PINNING ROOF PANEL TO THE ROOF DECK.